

**TID**2011 Award  
Taiwan Interior Design

空間家具 Space furniture

Floating punch

型構國際有限公司 Morpho International

主持設計師  
Chief Designer

方俊能 Fang, Jun-Nen

協同設計師  
Co-designer

賴元傑 Lai Yuan-Jie

攝影者  
Photographer

游宏祥 Kyle Yu

## Floating punch

此一基地位於原有診療中心旁，為新醫療需求而新增的空間。由於該空間定位為診療中心的VIP診療區。在維持原有單一入口與動線的情況下，必須封住整道沿街面，不做出入口。而這個條件因素也成了整個空間的設計核心。

將整道牆視為一件流線形的裝置物體—Object，自入口處延伸到沿街面，既是立牆，也是等候區的座椅，更是沿街面的一個巨大裝置端景。它既能阻隔外界接到多數人們的視線又能透過裝置量體的設計感，暗示此一VIP的特殊性。

The site is suited next to the existing clinic treatment center, the project proposal is acquired for the extension of the new treatment facilities. The exiting site condition is located within its VIP treatment area. by keeping singular entry axis, the proposal has change the original way of flow into the treatment centre, and becomes the main design concept of flow for the clinic center.

The initial concept is to seek the entire wall as a device, an singular elements which connects from entrance to the street scape. The wall forms part of the wall function as well as seating/ waiting area. it also acting as an iconic gesture for the design. The design not only extended the privacy of the interior view, but also offers a luxury of the VIP area through its design volume.

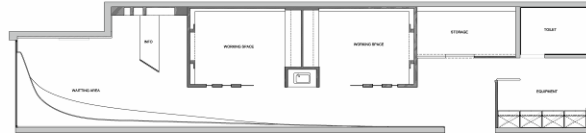



在簡單的基地中，我們試圖反向思考，在空間容器中撞進一巨型物件(傢俱)，任其盡情展演一場獨秀，再藉由它串連整合空間架構與使用需求。上演的是沉靜空間中的動態語彙，活動於內的時尚氛圍，簡單而具力道的視覺饗宴。

Within its simplicity of the space volume, the large container like object (furniture) will be serving as a singular performance of its own. By using its design form, it interconnects its structure and space volume into dynamic spaces. The vocabulary its given to its viewer as simple and strength through its visual effects.

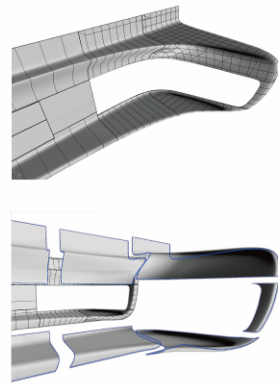
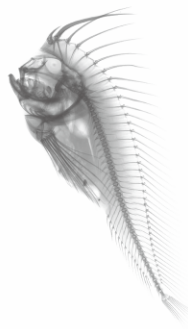

## Floating punch

當設計思考純粹簡化至需求層面時，讓空間中的物件恣意展現其姿態，翻轉空間主軸，他便儼然成為設計主角，接續的空間布局便依其而生，自然成型。

The spatial design is through its simplicity, allowing the object to perform its own uniquely. Turning the spatial volume into its own, extending the space layout through its transition of natural form morphing.

