

**TID** 2012 Award  
Taiwan Interior Design

居住空間/單層  
Residential space / Single Level

界·現  
definition

近境制作設計有限公司  
DESIGN APARTMENT

主持設計師 Chief Designer	唐忠漢 T T
協同設計師 Co-designer	王正行 White Wang
攝影者 Photographer	岑修賢 Sam 、高伊芬 Yvonne



Definition

界 | 現

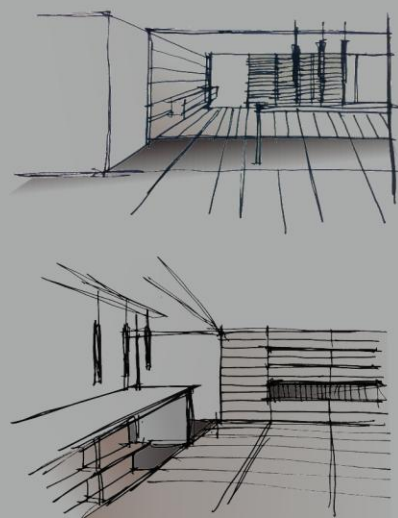

空間中以暗示性的三維軸線貫穿天花板、牆面、地板，整合並區分不同空間屬性  
Implied three-dimensional axis runs through the ceiling, walls, floor space, integrate and differentiate between different spatial attributes

## The hidden axis

Within the space, it has employed reduction as the primary axis that penetrates the entire design, and used the texture of the wooden flooring as the metaphor. It has got rid of the processing with standing profile, and continues with the texture of intermixing sky, earth, and wall, forming a hidden axis of suggestion. Most of all, it defines the space and exploits partition; at the same time, it stresses standing profile, telling, non-painstaking existence.

## 隱藏的軸線

在空間中，以減去做為貫穿整個設計的主軸，利用木地板本身的質地作為隱喻，捨去立面造型的處理並延續著天、地、壁相互交錯的肌理，形成一道暗示性的隱藏軸線，定義了空間使用區分，同時強調了立面，不刻意的存在。

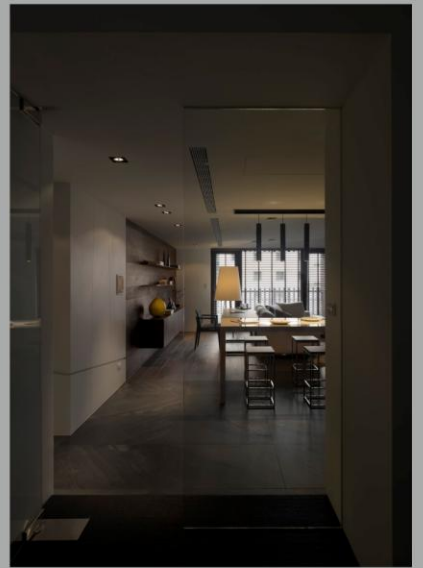

■ 單純材料質的延續延伸  
Continuation of the pure material quality extension

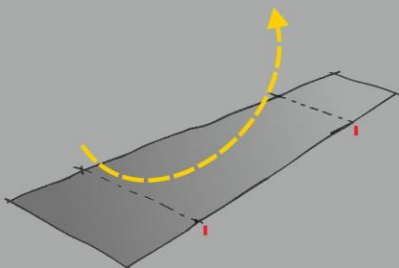

■ 賦與機能並串聯空間  
Endowed with functions and series space

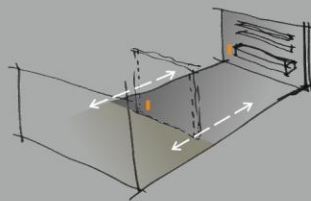

■ 連續動線並使氣流及光線自然滲入  
Continuous moving lines and air flow and natural light penetrate

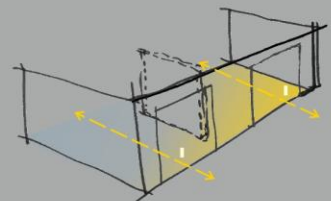



## Definition of space

After it has reduced original partition, it resorts to the mural wall hidden in between of two sliding doors as the partition interface as it defines the space of host room and living room. With the retention of connection and changeability of space, it has, on the one hand, introduced the largest size of aerial light, but also helped render the "air" and "route of movement" to move freely.

## 空間的界定

削減原有的隔間後，在主臥與起居空間的界定上，以一道暗藏兩樞拉門的牆面做為區分介面，保留空間的聯結及可變性，引進最大面積天光的同時，也能讓「空氣」和「動線」得以自在的流通。

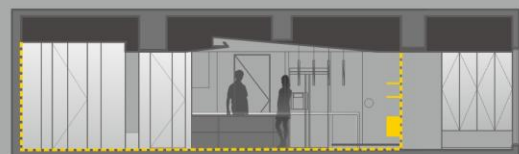

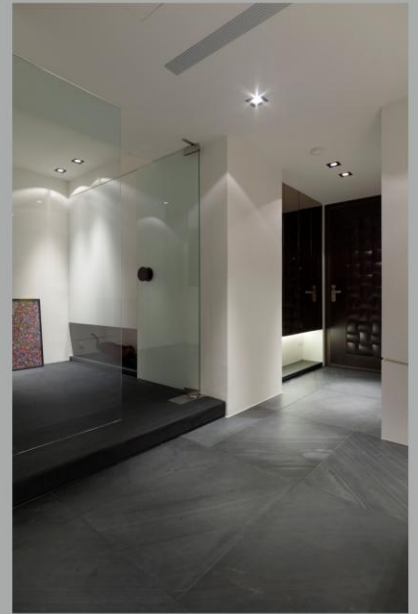

## Endowment of function/integration

As of the inherent conditions as constrained by the habitation, its size of use is relatively smaller, and it is why functionality integration is employed as the measures of processing. Thus, the extended platform of artificial stone is concurrently employed for use functional with cuisine preparation, dining conversation, and storage and display. As for the floor transitioned from the site of library space will, from natural crevasse, squeeze out such objects, and form the closet and laminates.

## 機能的賦予 | 整合

由於住居受限於先天的條件上，使用面積較小，因此以機能整合做為處理手法，延伸的人造石臺面形成同時具備料理操作、用餐對話及具備收納展示的使用機能，而書房空間則由自地坪轉折而起的地板自然溝縫擠出量體，形成了櫃體及層板。