

**TID** 2013 Award  
Taiwan Interior Design

居住空間/單層

The TID Award of Residential space / Single Level

空間層序

Leveling of space

近境制作設計有限公司

DESIGN APARTMENT

主持設計師

Chief Designer

唐忠漢 T T

協同設計師

Co-designer

袁丕宇 Yuan pi yu

攝影者

Photographer

游宏祥 Kyle Yu

空間層序

Leveling of space





### 穿透空間 以光潤室

電視主牆刻意壓低 與結構脫開 創造室內環繞動線 讓光線無阻礙的渲染空間

### Space transparency Light-beam to lubricate chambers

Primary all of TV is deliberately lowered and detached from the structure, create surrounding route of movement indoor, so that light unobstructed can heighten the space





### 以量體畫分區域

以電視牆為主題 用適當的尺度 切分公共區域空間 讓個空間獨立卻又互動

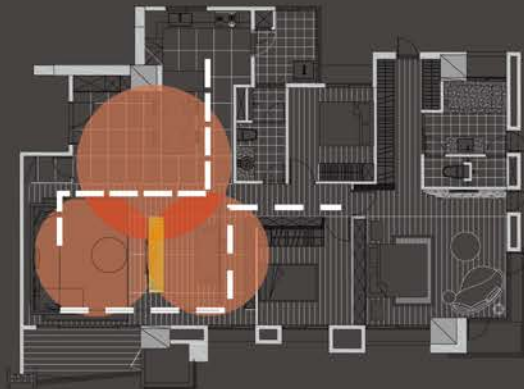

### Body weight used to partition areas

TV wall is used as the mainstay, cutting space of public domain with suitable scale, so that each space can be both independent yet interactive





### 開放式公共空間

以電視牆量體 以及地坪材質的不同 劃分出客廳 書房 餐廳 三個空間 以無隔間的概念將三個機能不同的空間整合在一起

### Open public space

TV wall is taken as the body weight, while difference of flooring materials partitions three separate spaces of living room, library, and dining room; then the concept of non-insulation will, again put these different spaces of three functions into oneness.





### 材質的延伸與交疊

玄關的黑色牆面 轉折後與客廳的白牆交疊 木地板延伸至書房牆面 轉折到走道 再以一白色轉角量體與其交疊

### Continuity and overlapping of materials

The black wall at the porch overlaps with the white wall of living room after the bend, whereas the wooden floor extends to wall surfacing of library, and it will, again, overlap with another white body weight as meandered to the aisle.

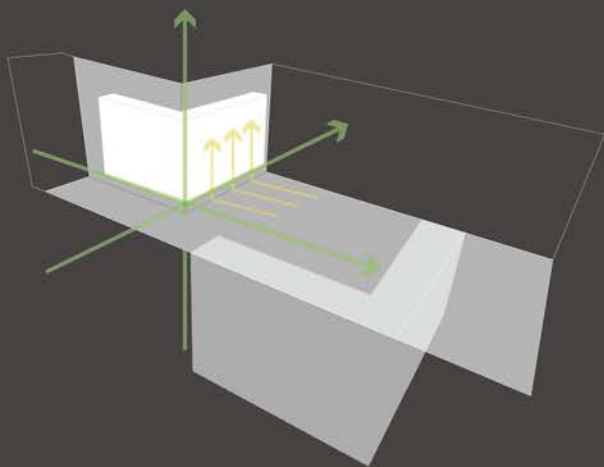



### 堆積的量體

已堆積的概念 用不同尺度的幾何方塊集成量體 用來貫穿公共與走道空間

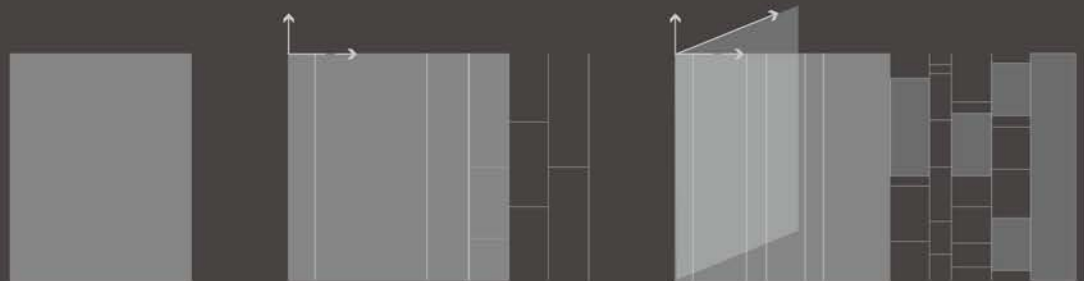

### Body weight of accumulation

The concept of accumulation builds up the geometric body weights with diverse scales, taken to penetrate the public and aisle space

