

**TID** 2015 Award  
Taiwan Interior Design

公共空間

The TID Award of Public space

EXPLODED CINEMA

壹正企劃有限公司

One Plus Partnership Limited

主持設計師  
Chief Designer

羅靈傑 Ajax Law Ling Kit

龍慧棋 Virginia Lung

攝影者  
Photographer

雷壇壇 Jonathan Leijonhufvud



# EXPLODED CINEMA

Location : Wuhan , China





EXPLODED CINEMA

Location : Wuhan , China





# EXPLODED CINEMA

Location : Wuhan , China

Trips to cinemas have always left the movie-goers contended with dazzles. While the audiences are watching the film in the auditorium, they could let their imagination run wild. Especially the science fiction film genres, like 'Inception' or 'Interstellar'. These films further ignite the audiences' creativity. The designers visualize the scenes from these movies, creating yet another vivid interior which welcomes the audiences as if they have walked into a real movie setting.

Upon entering the cinema, audiences' eyes would meet with the various-shaped and three dimensional boxes. Black and white engulfs the perimeter, conveying a hint of futuristic and multi-dimensional feeling appears in science fiction movies. Rectangular-shaped concessions and kiosk inclined with assorted angles, camouflaging themselves in the futuristic background, which triggers the association of meteors in space or the second element of psychedelic space. On the ceiling above the concession lays a rectangular LED box, which could play movies or dynamic graphics within the area. Black marble tiles with white veins coated the entire ground. The flooring, which is supposed to be a two dimensional object, fills with three dimensional geometric graphics, as if they are multifold of rectangular boxes emerging from the ground.

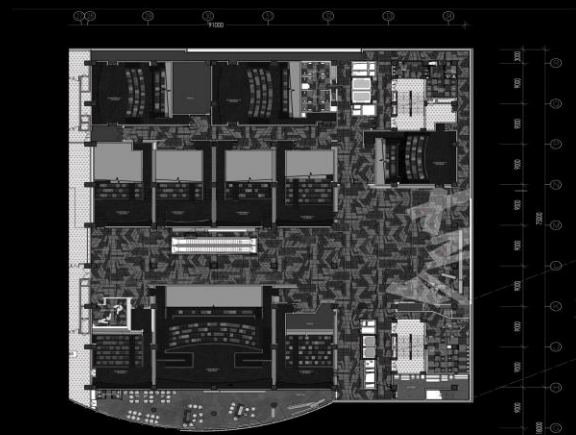



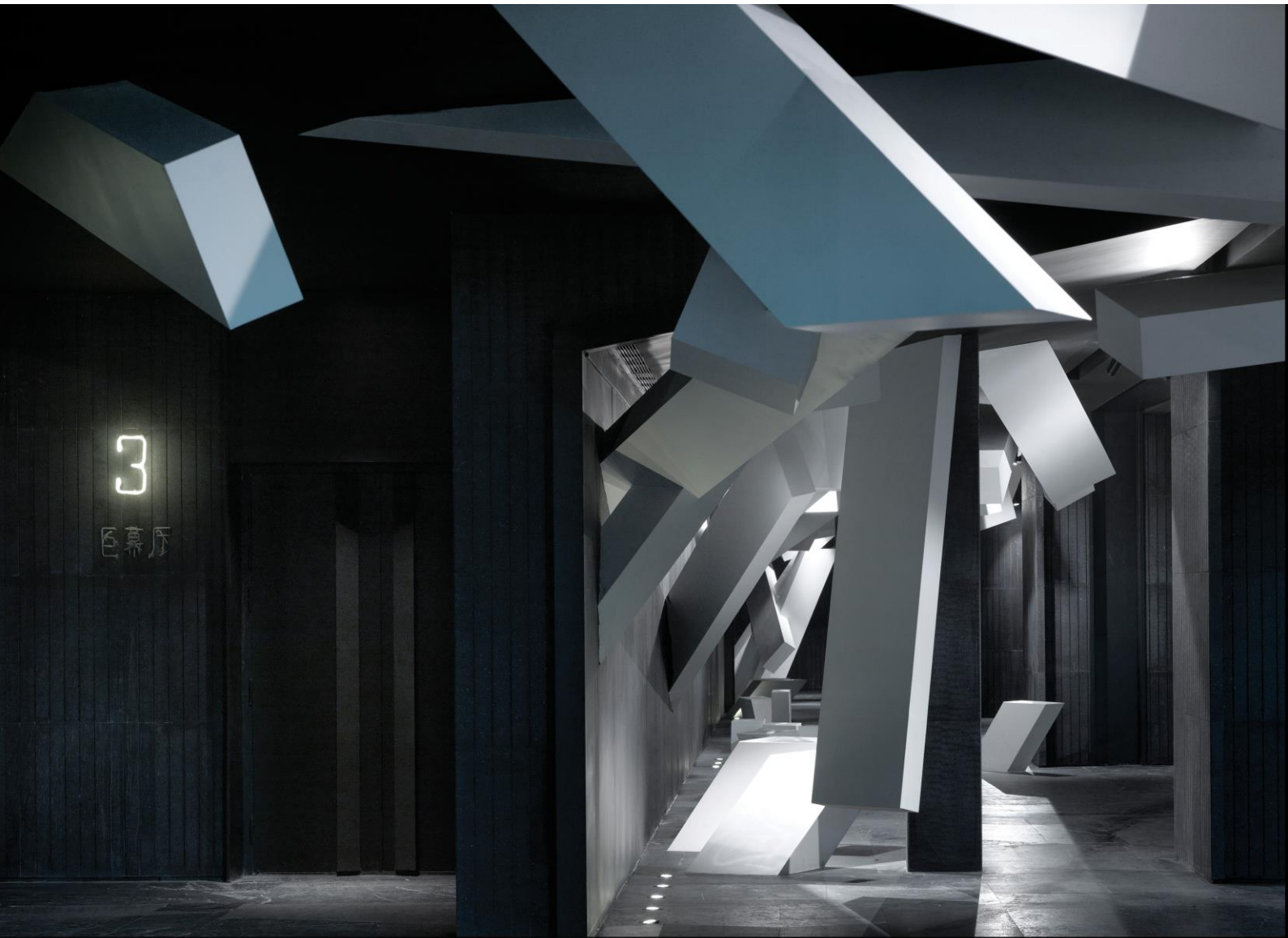

# EXPLODED CINEMA

Location : Wuhan , China

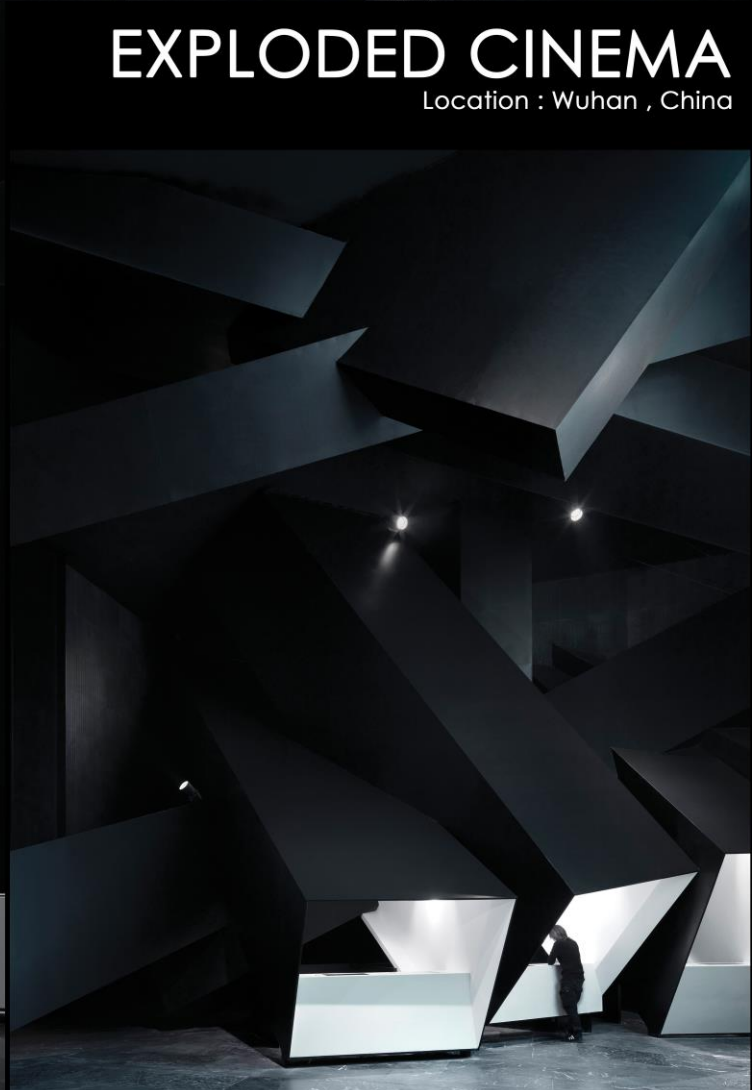



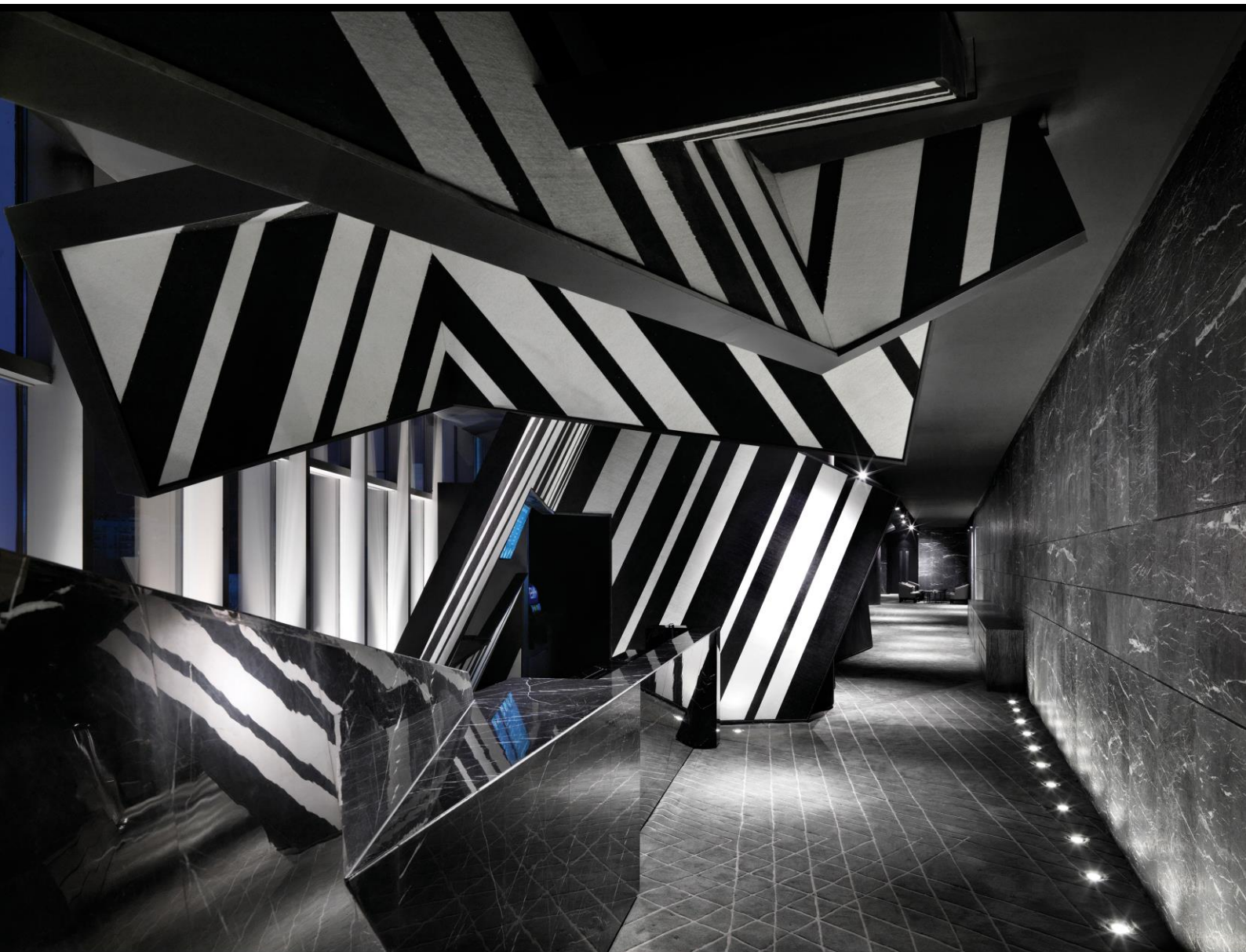

# EXPLODED CINEMA

Location : Wuhan , China

Along the corridor, the vibe of science fiction movies lingers. Several three dimensional white-coated metal pillars grow towards different directions, enacting the scenes out of someone's imagination, whereas objects were being placed randomly and scattered around. These irregularly-shaped pillars crisscrossed with each other to give a unique visual effect. Some of them even elongates into seats for people to take a rest. The lights on the ceiling also shaped like pillars, developing towards different directions and angles, visualizing the science fiction vibes further.

In the washroom, pillars elongate from the ceiling, minimizing the room space to create a sense of pressure. Several square basins look like the irregular objects that would only appear in the future. Grey three dimensional square-shaped boxes of sound absorbing materials surround the auditorium, pointing towards altered angles. Some boxes enclose light sources, which add a hint of mystery towards the whole design. With a monotone of grey engulfing the whole perimeter, the audience could certainly feel a sense of perplexing and secretive vibe that the designers created. Different lengths of black and white stripes in the VIP room continue the three dimensional theme, adding an edgy whiff to welcome the special guests.







# EXPLODED CINEMA

Location : Wuhan , China

