

TID 2015 Award
Taiwan Interior Design

居住空間/單層

The TID Award of Residential space / Single Level

砌。舍

Craft . Shed

創研空間設計有限公司

Create + Think Design Studio

主持設計師

Chief Designer

何俊宏 Arthur Ho

協同設計師

Co-designer

李逸珩 Yih-Heng Lee

王勝盈 Sheng-Ying Wang

王家淋 Jia Lin Wang

許展遠 Chan-Yuan Hsu

攝影者

Photographer

李國民 K.M.Lee



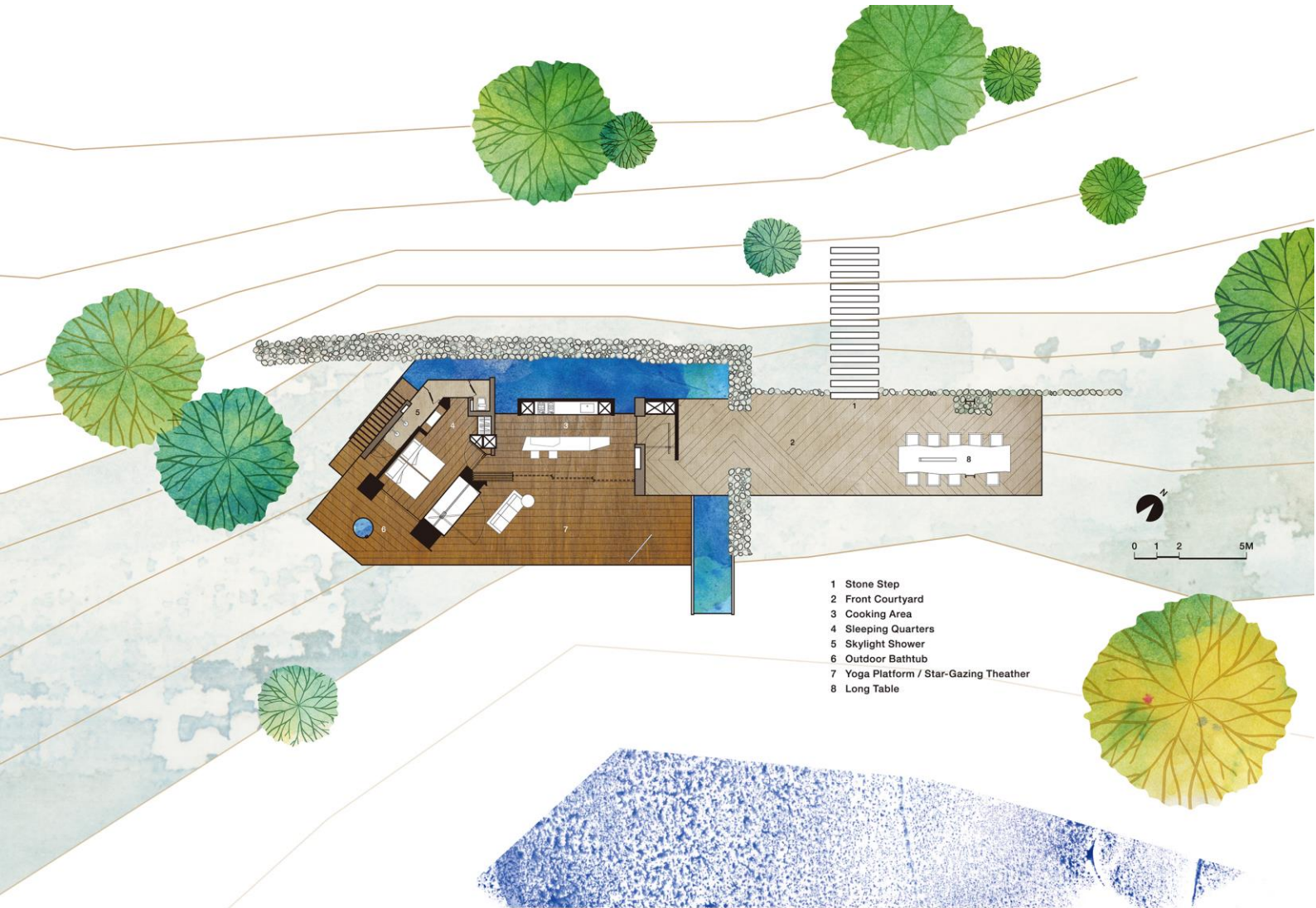

CRAFT / Construct with Wall of Stone
SHED / Simple Dwelling with Minimalist Living Space

The site is located on a steep hill adjacent to the ocean and excavated through a traditional method to form a livable foundation. The excavated stones are utilized as structure walls, wrapping the steel structural frame. Resting on the stone wall and facing the ocean, the low-profile structure extends and bends along the contour of the coastline.

The entrance of the structure is at the bottom of a stairway made of large stones. The diagonally cut granite floor establishes the dimension of the front courtyard, then connects with the granite wall that leads into the structure. The wall defines the courtyard, cooking area, and sleeping quarters. The entrance gives a glimpse of the L-shaped wall wrapping the structure. Following the contour of the coastline, the pool further accentuates the wall with another L-shape.

Surrounded by the serene beauty of mother nature, we have chosen a least invasive design that satisfies the basic shelter and food preparation needs. Hence, the interior consists only of cooking and sleeping areas. The spaces are defined by accordion glass doors, allowing light and air to flow freely throughout. One can be awed simultaneously by the immensity of the ocean or the stoicism of the stone wall. The auxiliary living spaces are utilitarian and symbiotic with the surrounding nature, such as the skylight covered shower and the outdoor bathtub just outside the sleeping areas, the al fresco dining area with the long table to the side of the foyer, and the multi-purpose area in front of the structure that can be a yoga platform or a star-gazing theater.

Shed, a simple dwelling with minimalist living space, contains within itself endless possibilities through a carefully constructed symbiosis with the surrounding nature.

砌 / 堆砌，砌石為牆
舍 / 簡易的房子，極小化的居所空間

基地位於臨海的陡坡上，以原始工法開挖，整理成一個可生活的平台；用基地內挖出的石頭，砌石為牆，環繞著鋼構的建築；扁平而延伸的建築物，背著石牆，面向大海，平行於海岸線，隨著海岸線轉折。

從一大石階拾級而下是建築物的入口；斜線分割花崗石材地坪定義了前院，地坪花崗石材轉折上牆引導進入建築；花崗石牆界定出-入口前院/烹煮空間/睡眠空間三個區塊；入口前院處看到砌石以L型環繞建築物，如入口意象圍牆又彷彿是建築物的表皮；呼應大海，水池也同砌石以L型環繞著建築物。

在大自然環繞下的居所需求，選擇最低度的方式，只需滿足遮風避雨藏身/取火煮食即可。於是，此居所的室內空間僅由生活必需之烹煮空間與睡眠空間組成。居所是可以以開闔的落地玻璃門窗所組構，光線空氣貫穿流動其間，可面向大海的開闔，或感受大石牆厚實環抱的力量；其他非生活必要空間採用與自然共生方式，睡眠空間外是天然淋浴區延伸的露天澡盆；半露天前院側的長桌是用餐區；建築物前方有戶外起居空間可以是瑜珈平台，可以是星空劇院，亦可以是任何的可能性空間。

舍，簡易且極小化的居所空間，透過與自然共生的方式，產生了無限延伸的可能...



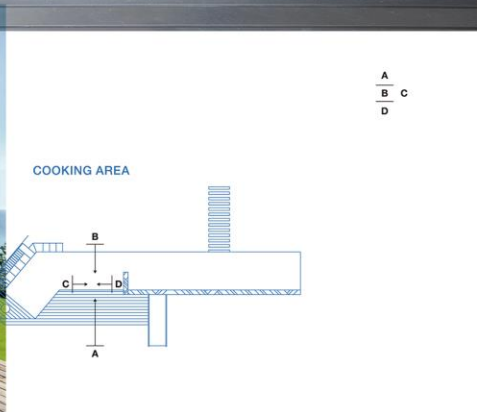

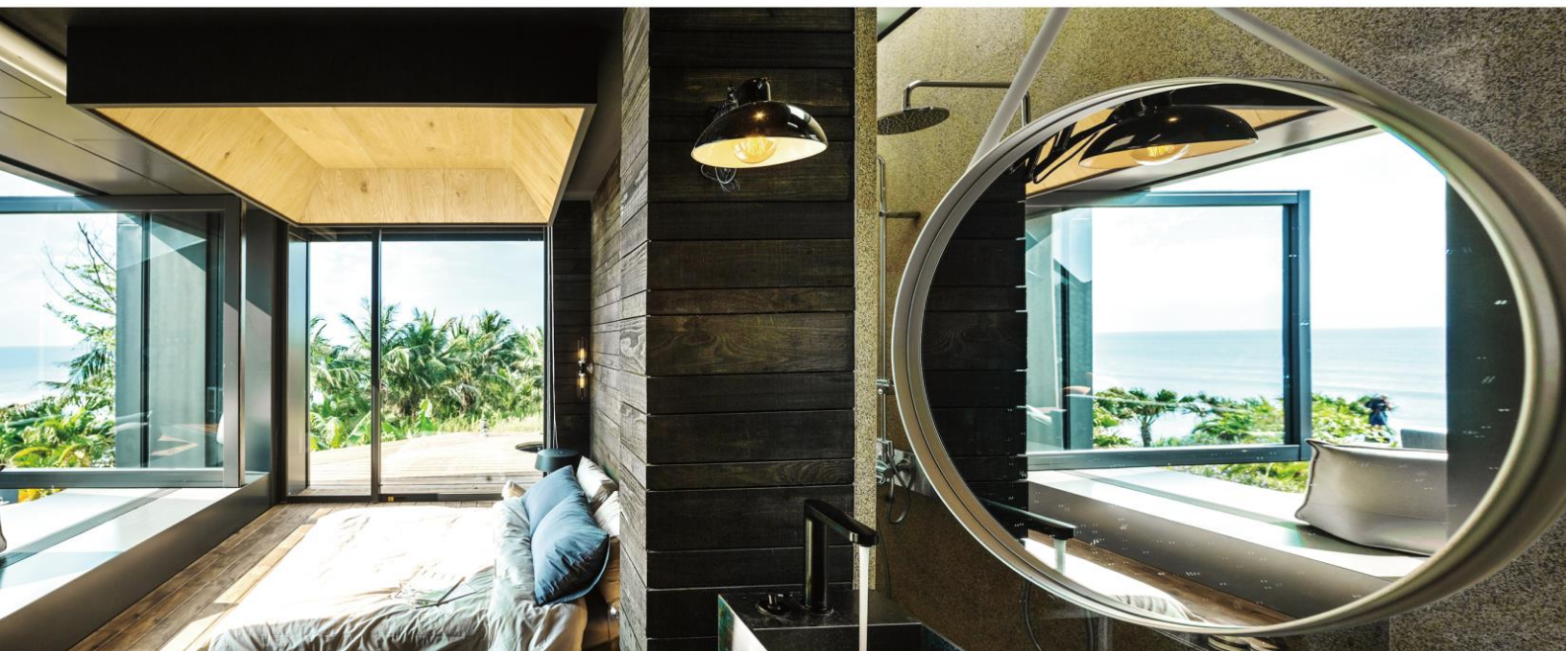



A
B C
D E

AUXILIARY LIVING SPACES

