



臨時建築與裝置類 TID 獎

The TID Award of Interim Architecture & Installation

途兒咖啡_城市單車綠洲實驗

Toward Café – Oasis Experiment of Urban Cycling

唐源設計室內裝修企業有限公司

TANG-YUAN Interior Design Enterprise Co.,Ltd.

主持設計師
Chief Designer

陳柏齊
Po-Chi Chen

攝影者
Photographer

林鉦凱
LIN CHENG KAI





健康只賣
非基改
純釀造

ride to go

ORDER HERE
ride to go
POWER WATER
SUPPLY FOR

RIDE THROUGH



toward
cafe



TOILET



toward cafe



toward

toward cafe



本場所全面禁煙



toward



ORDER HERE
ride to go
POWER/WATER
SUPPLY FOR

DO NOT ENTER



toward cafe



單車騎來速
小汽機車請停此處



gelato



單車騎來速



THE RIDE

gelato

ბიწვოთ
აქცე







toward everything.

upcycle ♡ earth ♡ bike ♡ health ♡ coffee ♡ soul.

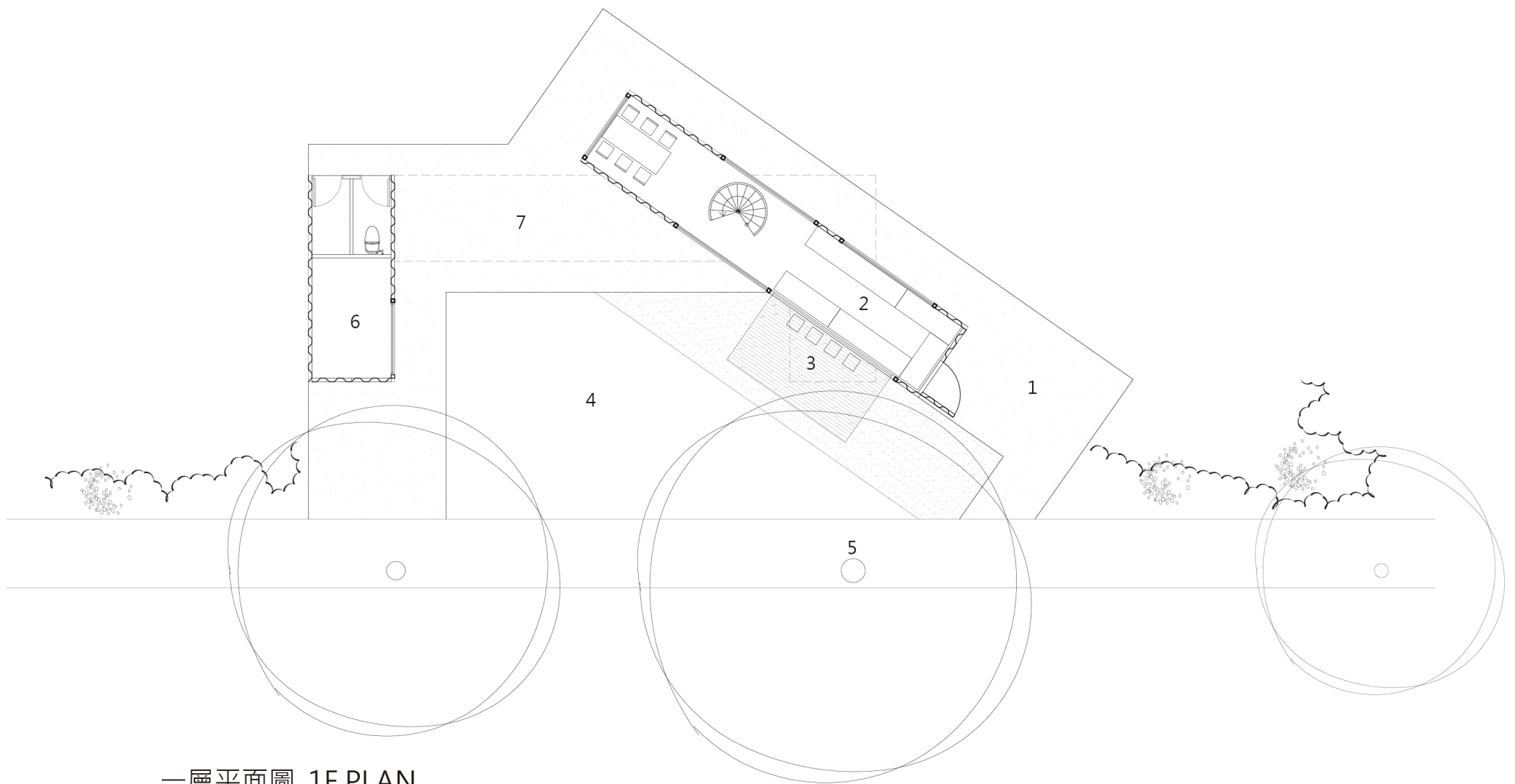

一層平面圖_1F PLAN

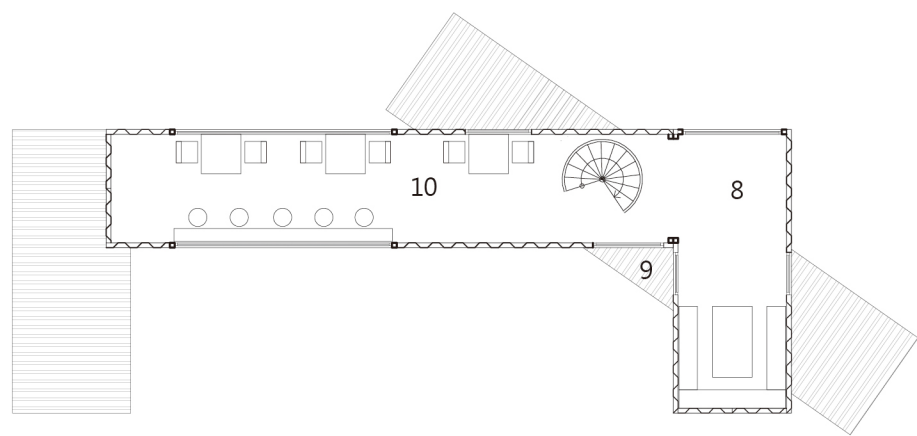

二層平面圖_2F PLAN

- 1 單車騎來速專用道
- 2 咖啡吧內場
- 3 電動升降平台
- 4 草地音樂會
- 5 行道樹
- 6 單車自助維修站
- 7 半戶外講演空間
- 8 轉角藝廊
- 9 樹影陽台
- 10 室內講演空間



IA-07-途兒咖啡館

途兒咖啡以「單車騎來速」為主軸，利用一年時間大膽且實驗性的點出目前都市空間對於單車友善環境的想像不應僅止於專用車道等行車安全的被動改善，更應主動完善單車休憩節點，讓「綠色運輸」過程更舒適，且更具啟發性。單車友善環境的整體營造，在未來城市綠色運輸網路的建構藍圖中扮演著關鍵的腳色。

使用二手貨櫃作為建築載體，從知性的角度來看是相對環保的，在建築過程中不會造成額外的碳排放量，作為綠色運輸中的休憩節點有其目標上的一致性；從感性的角度來看，二手貨櫃的外表訴說著它旅行的痕跡，各地旅人與物件在此聚集交互體驗，碰撞出新的感知經驗。

整體建物以二個四十呎貨櫃及二個二十呎貨櫃堆疊構築，嘗試使用盡可能少的材料與結構支撐，讓空間能夠較純粹地呈現出來。透過人行道退縮六米後建築，作為快速車道及慢速人行道的緩衝空間，前排行道樹、貨櫃量體及後排灌木植栽三個層次所夾擠出內圈屬於緩慢經驗的餐飲空間及外圈相對快速體驗的單車停等空間，快與慢在此並存、交互流動。利用下層貨櫃偏移旋轉的設計手法，同時創造出二樓內凹陽台與既有行道樹梢相連，及一樓前後兩個外凸雨遮，創造有趣的空間韻律。

白色，外顯的表現餐飲服務空間在都市街道尺度的自明性；黑色，內斂暗示活動於其中的旅人才是空間的主軸。減少外在投射光源的積極表現與光害，讓玻璃窗由內而外透出的溫潤燈光作為旅人故事發生的背景。這是場實驗，也是場行動宣言，挑戰著城市對於單車的想像。

IA-07- Toward Caf é — Oasis Experiment of Urban Cycling

On the basis of the idea “bike journey,” the Toward Caf é has been preparing for a year changing the ordinary public acknowledge, which is focused mainly on security for cyclist, into a comfortable service area for resting, a new idea making bike riding more meaningful and a crucial part of air pollution protection activity.

The used containers, designed for caf é servicing foods and drinks, present the idea of environmental protection. The process of construction meets the principle of reducing carbon emission, from the perspective practicality. In another view, in spiritual aspect, the exterior of used containers presents before people the diverse experiences of interaction among visitors, bikes and Toward Caf é .

Piling up two 4 feet and two 20 feet containers with the least construction materials, the main building for Toward Caf é , the designer excellently demonstrates the characteristics of space. Sparing 6 feet space way from the main street, mainly for pedestrians and cyclists, the designer has brought into existence the dining and parking areas by means of applying the characteristics of sidewalk trees, containers, and shrubs. The designer skill, placing the lower containers in different directions, creates spaces for balcony and weather shelters.

The white space presents the food servicing area and the black space is available for clients having foods and taking a break. The design idea for lighting, mainly from daylight, conceptually tells the story of Toward Caf é , which is trying to change the stereotypes for the activity of bike riding.