

TID11th2018Award
Taiwan Interior Design

商業空間類/購物空間 TID 獎

The TID Award of Commercial Space/Shopping Space

MINZE-STYLE 名師彙

MINZE-STYLE Select Shop

華伍德設計諮詢 (福建) 有限公司

Huawude Design Consulting (Fujian) Co.Ltd

主持設計師

Chief Designer

何華武 HUAWU HE













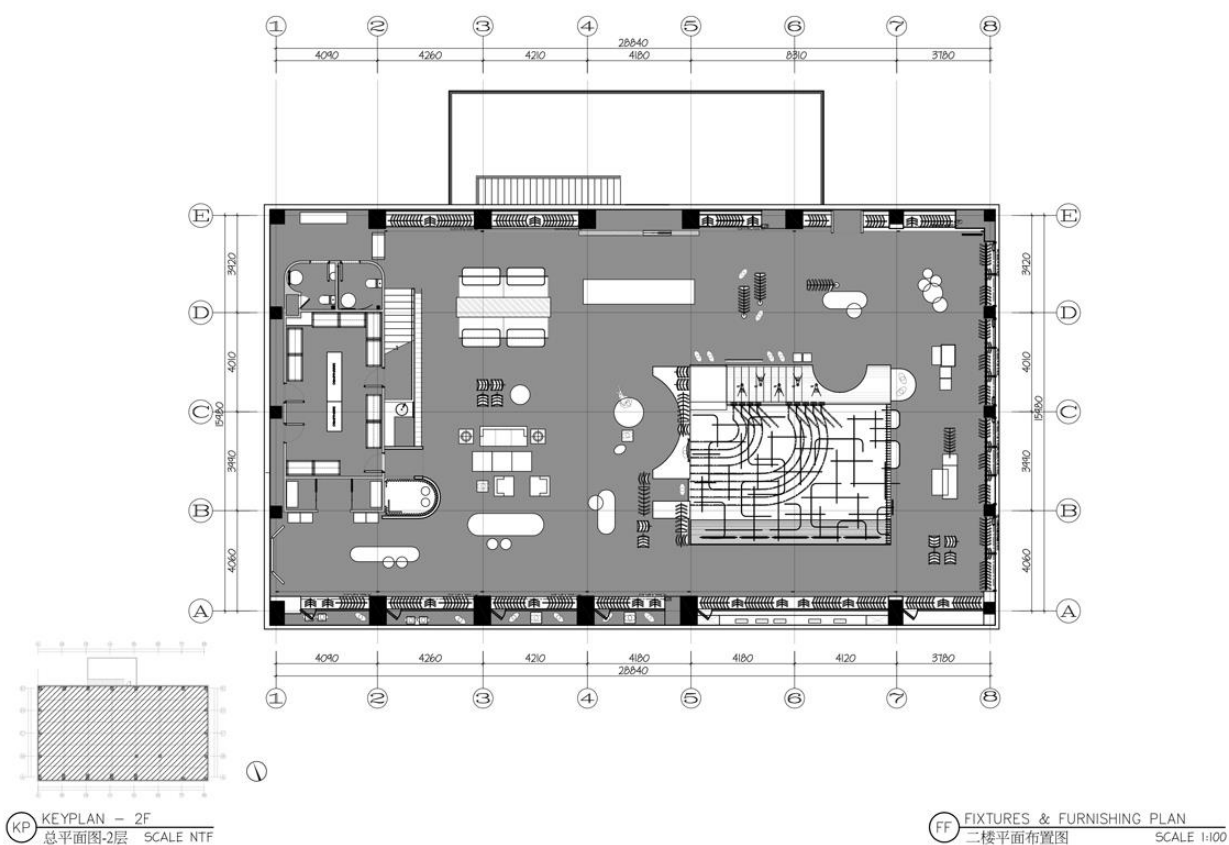

CSS-09-MINZE-STYLE 名師曼

MINZE-STYLE”一直是中國時尚潮女裝行業領先性品牌，他繼承著意大利時尚傳統魅力設計風格，結合東方大都市女性的形體美及世界各地不同流行元素。“MINZE-STYLE”時尚女裝突顯大都市國際化品質和中西兼容的文化格調，個性而不張揚，時尚傳承經典，經典與靈魂的結合。MINZE-STYLE 品牌集合店位于中心公園旁邊，基地以前是一個封閉的建築。設計開始結合現場周邊的綠色環境進行融合，設想在綠色中將建築消失成為一個出發點。我們在基本的層面，表達建築使用的材料，基地及物理現實世界的存在狀態，什麼是牆，什麼是表皮，什麼是透明，這些問題會立即影響觀察者與使用者的感官與感知能力。我們力求世界的物質性與感知的多元性，物質性必須突顯，才能展現空間藝術的特質。內部空間希望呈現一種原始野性的魅力，採用鋼制的表皮帶來一種現實感。這種“直白”式的架構材料，空間所形成的直接性與樸素性，加上大尺度的鋼板落地產生的力量感或輕盈感，使整個空間與原有場地建築取得一種時間與空間的接續關係。利用“拱”多變的空間特性，產生不同的空間，打破了均質的體驗。這是一個回憶的過程，再一次將建築的體量與空間對話，越是簡單的形體邏輯，越能給人帶來深刻的印象，弧拱曲線柔和，呈現不同角度的美感。弧拱的連續曲線把空間構造成圍合區域，在這樣的方式下，內部和外部保持著空間的連續性，這個理念使空間不拘泥於常規，探索傳統類型空間的新秩序，“拱”在傳統建築中扮演重要角色，並且在漫長的歷史中不斷豐富。我們試圖轉化傳統“拱”，讓“拱”在均質呆板的現代空間上制造新的突破，獲得自然能量並把它轉化為空間秩序。

CSS-09-MINZE-STYLE Select Shop

MINZE-STYLE has always been a leading brand in the women's fashion industry of China. It inherits the traditional design style of Italian fashion while incorporating with the physical beauty of oriental ladies in metropolis and various popular elements around the world. MINZE-STYLE highlights the metropolitan quality and combines Chinese cultural styles with those of the Western World: personalized but restrained, stylish yet classical, presenting an integrity of classics and soul. The MINZE-STYLE Select Shop is located next to the Central Park, which was an enclosed building. The design was initially incorporated with the surrounding environment by envisioning it as a starting point of the greening. We would like to present the building materials used, the status of the site and the physical world, as well as the walls, the facing, and transparency straightforwardly, as these would immediately influence the senses and perceptions of the observers and the users. We strive to have the materiality of the world and the diversity of perceptions to stand out, so as to display the characteristics of the spatial art. The interior space is supposed to present the charm of the primitive and wild nature, and steel cladding is used to bring out a sense of reality.